

# GSM remote camera

## User manual

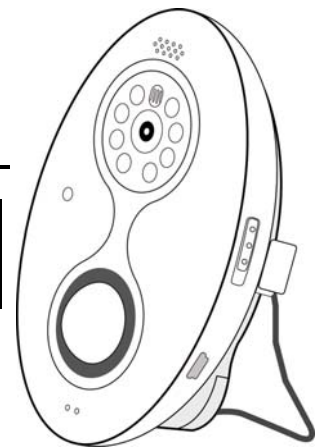

- !**
1. The GSM SIM card for GSM camera should be PIN code de-activated, and it needs to activate caller ID presentation & MMS functions.
  2. Be sure to remember and keep the product's password, SIM card number secret. Don't disclose them to others to ensure your privacy safety.

### Chapter 1 Product Feature

1. This product needs to use GSM SIM card. It can send MMS images to MMS enabled mobile phone with a color display or to an e-mail address.
2. Intergrated PIR detector to provide precise and timely alarm.
3. Built-in CMOS camera and infrared LED. Even in dark environment, camera can get clear images.
4. SMS remote control: User can control the camera by SMS command or calling.
5. Listen in the monitoring area: Call the device number to listen in monitoring area.
6. Build in speaker: User's voice can be broadcasted via build-in speaker to scare the unvited vistor.
7. Multimode alarm: Camera can send alarm messages by SMS, MMS, E-mail or standard phone-call.
8. Schedule monitor: User can set the camera working as the preset schedule.
9. Built-in Lithium battery: Rechargeable battery ensures operation in case of external power failure.
10. Easy installation: Wireless connection. The product can be installed at any place you want.

#### Product Accessories



Camera  
(1 unit)

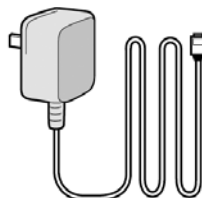

Power adapter  
(1 PC)



User manual  
(1 PC)

### Chapter 2 Host Instruction

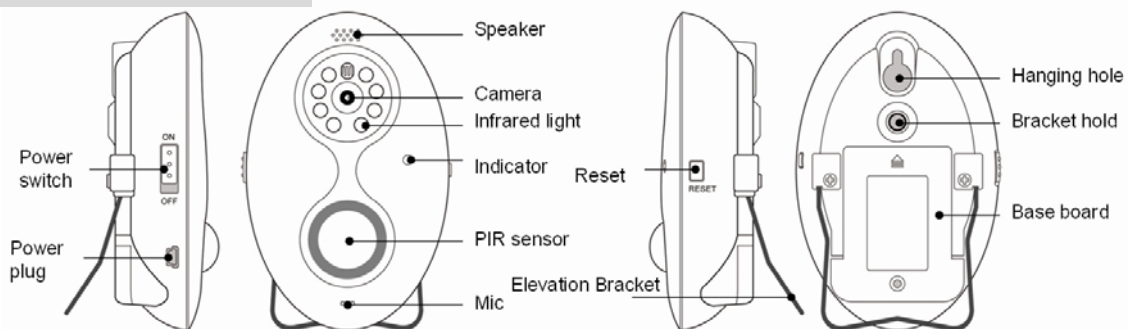

#### Indicator Status Instruction

Indicator Status Instruction as follower:

Color	Action	Status
Red	Flash slowly	Searching the network.
	Flash quickly	Infrared body detect alarm
	Constant Light	Not installed SIM card, or the remote camera damaged.
Green	Constant Light	Defense status. Activating the auto-alarm function.
	Flash slowly	Cancel defense status. Canceling the auto-alarm function.
	Flash quickly	Processing data.
	Light two seconds	Successfully resume to factory setting. Note: Swith on the camera, after the indicator light flash red, press the RESET button until the indicator light turns to green, and then release the RESET button. The device is resumed to default setting.

Note:

1. Slow flash is defined as indicator flash 1 time per second, quick flash is defined as 2 times per second.
2. Under normal condition, press the RESET button of camera for more than 10 seconds to close or open the host indicator. This can also be done by sms command from mobile.

## Install the SIM card

**Note:** This device only supports GSM network. The Caller ID presentation and MMS function of the SIM card must be activated. Contact your SIM card provider for more information about the SIM card additional services.

Hold the camera, push downwards the back side of the camera, take out the battery, find the SIM card slot in the middle, insert the SIM card with the direction as the mark, then place back the battery and host base cover.

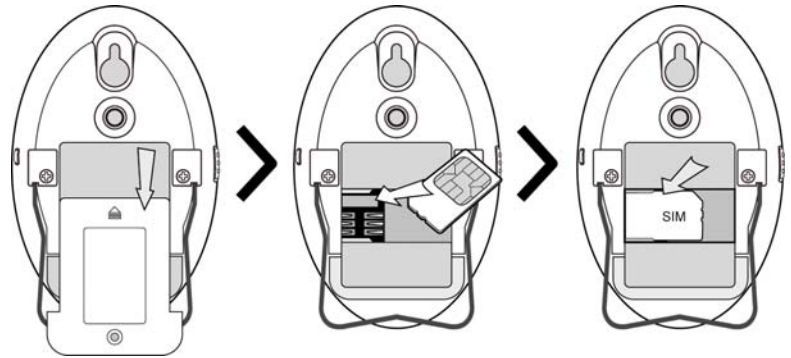

## Chapter3 Quick Start

### About the SMS Command:

- 1) All the SMS commands are composed with symbol # and Arabic numerals.
  - 2) Master & family SMS command format: **#code#content#**
  - 3) Guest SMS command format: **#code#password#content#**
  - 4) Password is a four-digit number. The default is 1234.
  - 5) The maximum digit of the phone number is 16.
  - 6) When camera receives the SMS command, it will automatically reply.
- Note:**
1. The symbol “#” in SMS command can not be ignored. No space character can be included within the commands.
  2. Two SMS commands or more can be sent in one SMS at the same time. Different SMS commands must be apart with semicolon in English.
  3. The max length of SMS parameters is 50 characters or digits.

### 1. Start the camera

The device should be bind with Master phone mobile for the first use or after resuming to factory settings. After binding with master mobile phone, the device can automatically sends alarm SMS to master once alarm triggered.

**Method 1:** Call the device with your mobile. The call will be hung up after connected, which indicate that your mobile number has been recognized as master.

**Method 2:** Edit and send the following SMS to camera: **#00#**

After setting, the device will send the following SMS to your mobile: **“Welcome! Password: 1234”**.

### 2. Network parameter setting

The user sends following SMS message in order to:

Set MMS center: **#124#MMScenter#**

- The MMScenter should be the MMS center address of GSM provider. For example: **#124#http://mmsc.monternet.com#**

Set APN parameters: **#125#GatewayIP#WAPGatewayPort# HTTPGatewayPort#APN#APNusername#APNpassword#**

For example: **#125#10.0.0.172#9201#80# cmwap#wap#wap#**

Successful SMS reply : Para:\*\*\*\*\*

Set sending MMS message via WAP: **#148#0#**

Sending MMS message via HTTP: **#148#1#**

### 3. Switch the camera defense status

Arm the camera is to activate the alarm function of remote camera. In this status, the infrared body detector is in work status. Disarm the camera is to deactivate the alarm function of the device. The connected PIR detector will not work. The device will not automatically alarm.

There are three methods to switch the defense status.

**Method 1:**

Edit and send following text message to arm the camera: **#01#**

The device will reply you that arm the camera successfully with SMS content **“Armed successfully!”** the device indicator flash still green.

Edit and send following text message to disarm the camera: **#02#**

Device will reply you that disarm the camera successfully with SMS content **“Disarmed successfully!”** and the camera indicator flash slow green.

**Method 2:** Call the device through master number or family number. Hang up in 5 seconds after hearing the ringing tone.

**Method 3:** Press “RESET” button for 5 seconds to arm/disarm the device.

**Note:** If you reset the defense state repeatedly, the device will reply to notify you that the device is armed or disarmed already.

### 4. Timing arm the camera

Timing arm the camera: The camera can set on defense automatically according to the preset time schedule.

To set timing arm the camera, you can do as following:

Set on timing arm the camera: **#128#1#**. You will get reply SMS **“Arming scheduler activated”**

Set off timing arm the camera: **#128#0#**. You will get reply SMS **“Arming scheduler deactivated”**

### 5. Capture image

**Method 1:** Master number or family number call the device and hand up within 5-20 seconds after hearing the ringing tone. The device will reply SMS **“Your request has been received. The device is sending image(s) now.”** And the caller can receive the MMS image later.

**Method 2:** Send following SMS command to camera:

For master number and families number: **#03# image quantity #**

For guest number: **#03#password# image quantity #**

The camera will reply “Image capturing request received. The camera is busy sending the MMS image.” And the caller will receive the MMS image later.

**Note:** When the image size is set as 160x128 or 320x240, the device can only send max 8 images one time. So the image quantity number should be in the range of 1-8. When the image size is set as 640x480, the device can send up to 2 images and the image quantity number should be 1 or 2.

## 6. Alarm setting

If the built-in PIR detector is triggered, the camera will alarm by sending SMS notify, MMS image and making a call. If you set sending SMS, MMS and calling as the default alarm way at the same time, once alarm triggered, the camera will send SMS, MMS, and then calling. Each alarm way will be carried once each time. For calling alarm way, the device will dial the master number and family number. If there is no answer, it will quit the dialing mode after repeated calling three times.

## 7. Listen in live voice

Master or family numbers call the device. It will answer the call automatically. Then you can listen in live voice of monitoring area.

## 8. Check status

If the user wants to know the present setting and work status of the device, just needs to send one of following SMS to camera and the camera will reply a MMS image including all settings (Not including the password.).

For master user and family user : #07#

For guest: #07#password#

## 9. Reset camera

Method 1: Swith on the camera, after the indicator light flash red, press the RESET button until the indicator light turns to green, and then release the RESET button. The device is resumed to default setting.

Method 2: Master sends SMS to camera: #08#password#

The reply SMS you get "Factory settings have been restored successfully"

## 10. Getting help

If forget the SMS command, user can send SMS to get help. The device will send the command list or user guide to user's cell phone by SMS or MMS.

### Get normal command help:

User sends following SMS command to the device:

For master user and family user: #09#

For guest: #09#password#

# Chapter 4 Maintenance

1. Store and use the device in suitable temperature. Too high or too low temperature will likely to damage the device.
2. Try to keep the host and all its accessories dry. Do not store and use it in the bathroom, or other place with high humidity. Do not allow pour water or other liquids into the device, otherwise, it might cause malfunctions.
3. Do not store and use the device in dusty.
4. Do not use alcohol, acetone and other similar solvents to clean it. Wipe it with soft-wet cloth.
5. Do not attempt to open it except as instructed. If the device does not work normally, try to resolve it as the guide of the "general troubleshooting". For the problem can not be solved, contact with the dealer immediately.
6. To prolong the life-span of the battery, connect the device to the power supply to charge the built-in Lithium battery for 4 hours every 3 months if the camera does not use for long time. Charge the battery at least 12 hours at the first time use to achieve the full performance of the battery.

# Chapter 5 General Troubleshooting

No.	General Trouble	Possible Reason	Solution
1	Indicator light does not work	The indicator light is closed	Press the RESET button for 10 seconds or send text message to open the indicator light.
2	Can't start device (Indicator works normally)	Already binded master user for the camera.	Recover to factory default setting.
3	All functions disable (Indicator works normally)	Caller ID presentation or MMS functions of the SIM card are not actived, insufficient fee of the SIM card.	Contact network provider to active SIM card function. Pay for the card.
4	Indicator light is still green	Can't find or identify the SIM card.	SIM card was not installed properly: Power off the camera and check it again.
5	The device doesn't respond to any operation.	Device work abnormally.	Switch off the power, check SIM card, or reset factory setting.
6	After starting the device, indicator flashes in red color and can not turn to green.	Network signal is weak or network is busy.	Place the camera at other place with strong signal and try again.
		SIM card PIN code is actived.	Close the PIN code.
		SIM card invalid.	Contact with local network operator to check of it.
		Do not bind a master user to the device	Bind a master user to the device
7	Can't start the device after long time supply with the battery.	Battery runs out of power.	Connect the camera to external AC power and charge for at least one hour, then restart device.

Note: If the problem can't be solved with above guidelines, contact to your local distributor or the factory.

## Appendix: SMS command list

(Only guest user needs add password 1234 in the SMS command, after changing the password, please change the command accordingly.)

User	Function	SMS Command
Master	Start the device	#00# Refer to Chapter 3. Quick start, 1.Start the camera.
Master and family	Arm the device	#01# Refer to Chapter 3. Quick start, 3. Switch the camera defense status.
	Disarm the device	#02# Refer to Chapter 3. Quick start, 3. Switch the camera defense status.
Mater/family / guest	Capture MMS Image	#03#password#image quantity# Refer to Chapter 3, Quick start, 5.Capture images.
Master	Change the password	#04#old password#new password#
Master	Add family number	#06#family number# You are allowed to add up to 10 different family numbers.
Master/family/ guest	Check the statues	#07# #07#password# Refer to Chapter 3, Quick start, 8 Check statues
Master	Resume to default setting	#08#password# The password is 4 digits
Master/family / guest	Get Usual command list	#09#password# #09#password#1# Refer to Chapter 3 Quick start, 10 Getting help
Master/family	Disable SMS notification when alarm	#11#0#
	Send SMS notification when alarm (default)	#11#1#
Master/family	Disable MMS image when alarm	#12#0#
	Send MMS image notification when alarm (default)	#12#1#
Master/family	Disable calling when alarm (Default)	#13#0#
	Set Calling when alarm	#13#1#
Master	Change master number	#14#new master number# The number should be less than 16 digits
Master/family/ guest	Send MMS image to appointed mobile phone	#30#password#mobile number#image quantity#
Master/family	Deactivate infrared detector	#31#0#
	Activate infrared detector	#31#1#
Master/family	Change auto alarm image size	#32#value# Value 1: 160×128 2: 320×240 (QVGA default) 3: 640×480 (VGA) For example: #32#1# means auto alarm image size is 160*128.
Master/family	Change auto alarm image quantity	#33# quantity# The quantity range: 2-8, default is 5. If image size is 640×480, the quantity is 1 or 2.
Master/family	Set image brightness	#34# value# The value should be: 1,2,3,4,5 (1 is darkest, 5 is brightest), default value is 4.
Master/family	Set Image direction	#35# value# The value 1 means up down, 2: left, right; 3: normal.
Master/family	Set Image contrast	#38# value# The value should be 1,2,3,4,5, default value is 4.
Master/family	Set interval of auto capturing image	#103#time# Interval time should be 3-10, unit is 0.1 second, default value is 5.
Master/family	Add or modify E-mail address.	#108#E-mail address#. You can only set one email.
	Delete E-mail	#109#Email address#
Master/family	Disable sending MMS image to E-mail when alarm (Default)	#110#0#
	Send MMS image to E-mail when alarm	#110#1#
Master/family	Delete family user	#113#family user# Note: Specify the family user you want to detele, for #113# means delete all the family users.
Master/family	Set timing send MMS image	#115#1#
	Disable timing send MMS image	#115#0#
Master/family	Set time period of auto send MMS image	#116#work day#period1 start time#period1 end time#period1 interval#period2 start time#period2 end time#period 2 interval#period3 start time#period3 end time#period3 interval#. For example,#116#1#0800#1200#1430#1630#30# means during 8 AM to 12 AM and 2:30 PM to 4:30 PM of every Monday, the device will auto send out a MMS image in every 30 minutes. <b>Work day:</b> (one digit, 0-8) 0 for everyday; 8 means from Monday to Friday; 1 for Monday; 2 for Tuesday; 3 for Wednesday; 4 for Thursday; 5 for Friday; 6 for Saturday; 7 for Sunday. Start time-end time: (4 digits, 24 hours, such as 0000 means 00:00AM, 2359 means 11.59 PM)). Interval time: (1-3 digits, 1-480, means sending MMS image interval) 1-480 minutes interval.
Master	Lock camera and SIM card	#117#value 1#value 2#value 3# Value 1 can be choose from 0 and 1, 0 means not lock sim card, 1 means lock sim card. Value 2 can be choose from 0 and 1, 0 means not lock camera, 1 means lock camera. Value 3 can be choose from 0 and 1, 0 means not lock operator
Master/family	Activate infrared body detector	#118#1#
	Deactivate infrared body detector	#118#0#
Master/family	Set MMS center	#124#MMS center#
Master/family	Set APN parameter	#125#gateway IP#wap port#http port#APN#APN user name#APN password# Note: Don't omit the symbol # even when the APN user and APN password are blank.
Master/family	Change language	#127#value# 0 means Chinese , 1 means English
Master/family	Timing arm the device	#128#value# Refer to Chapter 3, Quick start, 3.Timing arm the camera.
Master/family	Set timing arm the device schedule	#129#work day#period 1 arm time#period 1 disarm time#period 2 arm time#period 2 disarm time#period 3 arm time#period 3 disarm time# Please find instruction of work day, arm time and disarm time in "Set time period of auto send MMS"
Master/family	Close/ Open indicator	#143#value# The value can be 0 or 1, 0 means close the indicator, 1 means open the indicator, default setting is 1.
Master/family	Disable SMS notification when the power changed	#144#0#
	Send SMS notification when the power changed	#144#1#
Master/ family	Set MMS sending way	#148#value# Value 1 means MMS sent by Http way; Value 0 means MMS sent by WAP way.
Master/ family	Close/open the speaker	#164#value# Value 0 means close, value 1 means open.
Master/ family	Regulate device time	#152#number# Number is the device SIM number. This command is used to regulate device time.